

Program

MONDAY 13th May

TIME & SESSION

Speaker

12.30pm - Registration and Arrival Coffee	Pre-Function Lounge, Level 17
2.00pm-2.35pm - OPENING SESSION	Function Room, Level 17
Call to attention and welcome	
Welcome to Country	Uncle Colin Hunter, Wurundjeri Nation Didgeridoo played by Ganga Giri
Torres Strait Islander Prayer	Geary "Billy" Bann, Torre Strait Island Regional Council
Opening Address	Tim Richardson MP, Victorian Parliamentary Secretary for Health Infrastructure, Mental Health and Suicide Prevention
2.35pm-3.30pm Afternoon Tea	Pre-Function Lounge, Level 17
2.45pm Aboriginal & Torres Strait Islander Delegates' Meeting	Facilitated by Phillip Graham, Deputy Chair, ERPATSIEH
3.30pm-6.00pm - SESSION 1	Function Room, Level 17
Welcome on behalf ERPATSIEH	Phillip Graham, Deputy Chair, ERPATSIEH
Keynote Address	Dr. Jill Gallagher AO
Interview with Dr. Jill Gallagher AO	Interviewer: Nicole McCartney Chief Aboriginal Health Adviser, Aboriginal Health and Wellbeing Division, Department of Health, VIC
Environmental health SA	Phillip Graham, Department of Health and Wellbeing, Jacinda Amos, Flinders & Upper North Local Health Network and Nash Sam, Pika Wiya Health Service Aboriginal Corporation, SA
Stepping up to stop Strep A; The environmental way	Rahaney Poelina, Nirrumbuk Environmental Health and Services, WA
Q&A Session	
Close day 1 and housekeeping	
Group photograph	Function Room, Level 17
6.00pm-7.30pm Welcome Function	Pre-Function Lounge, Level 17

POSTER PRESENTATIONS 14th & 16th May

at Lunchtime in the Function Room, Level 17

School and clinical-based experimentation to ascertain Streptococcus pyogenes (Strep A) transmission	Stephanie Enkel, Thel Hla, Bernadette Wong, Abbey Ford, Janessa Pickering, Liam Bedford, Slade Sibosado, Hannah Thomas, Nina Lansbury, Jonathan Carapetis, Laurens Manning and Asha C. Bowen, Telethon Kids Institute, WA
Ringworm in cats and dogs – Insights for environmental health and animal management	Dr. Jessica Hoopes and Dr. Bonny Cumming, AMRRIC, NT
We're all connected – Using research to improve animal health and management programs	Dr. Jessica Hoopes and Bindee Davis, AMRRIC, NT
Environmental health in remote community homes to reduce rheumatic heart disease	Assoc. Prof. Nina Lansbury, Prof. Paul Memmott and Dr. Andrew Redmond, University of Queensland, QLD
Scholarships for Aboriginal people to study an environmental health degree in NSW	Kerryn Lawrence and Kelly Main, NSW Health, NSW
A multi-disciplinary approach to tackling strongyloidiasis	Kirstin Ross, Vanessa Marika, Michael Spry, Greg Pratt, Sean Taylor, Tamara Riley, Mick Adams, Catherine Gordon, Jessica Hoopes, John Kaldor, Matthew Watts, Polydor Ngoy Mutombo, Rogan Lee, Beverley-Ann Biggs, Bonny Cumming, Bronwyn Rossingh, Wendy Page, Jenni Judd, Jenny Shield, Richard Bradbury, Rahmah Noordin, Siddhartha Mahanty, Stephen Muhi and Darren Gray, Multiple Affiliations

Tuesday 14th May

TIME & SESSION

Speaker

8.00am - Registration and Arrival Coffee

Pre-Function Lounge, Level 17

8.55am-10.40am - SESSION 2

Function Room, Level 17

Call to attention and welcome

Keynote Address

Prof. Tony Capon, Monash University, VIC

Healthy Housing (Queensland) Pilot Program (HHP)

Brad Milligan, Tropical Public Health Services (Cairns),
Tito Burns and Stephen Canendo,
Yarrabah Aboriginal Shire Council, QLD

A multi-disciplinary approach to delivering the Healthy
Housing (Queensland) Pilot Program

Tricia Dixon and Louisa Ahmat, Tropical Public Health
Services (Cairns) and Karyche Bowie, Torres Strait Island
Regional Council, QLD

Emerging diseases and environmental health through a
wildlife health lens

Dr. Joanne Walker, Wildlife Health Australia, NSW

Q&A Session

10.40am-11.10am Morning Tea

Pre-Function Lounge, Level 17

11.10am-12.40pm - SESSION 3

Function Room, Level 17

Implementing healthy living practices through public health
programs in Yarrabah

Renee Grosso, Hayden Ernst and Harley Thaiday,
Gurriny Yealamucka Health Service
Aboriginal Corporation, QLD

Taking an environmental health approach to preventing Acute
Rheumatic Fever

Prof. Asha Bowen and Rachel Burgess on behalf of all STARFISH
Investigators, Telethon Kids Institute, WA

Waste Worriers - Struggle to conquer waste management
challenges

Aquila Gela and Susannah Mosby,
Torres Strait Island Regional Council, QLD

Environmental health operations in the East Pilbara

Chris Rusten and Rex Booth,
Puntukurnu Aboriginal Medical Service, WA

Q&A Session

12.40pm-1.40pm Lunch

Pre-Function Lounge, Level 17

1.00pm-1.20pm Poster Presentations

Function Room, Level 17

1.40pm-3.15pm - SESSION 4

Function Room, Level 17

Victorian Aboriginal Community Controlled Health
Organisation (VACCHO)

Abe Ropitini, Executive Director Population Health, VIC

Q&A Session

Exploring the nexus: Environmental health, mental health and
housing

Joseph Bin Omar, Department of Health, WA

Supporting the workforce development of Indigenous
Environmental Health Practitioners

Michelle Barrett, Australian Indigenous HealthInfoNet, WA

Q&A Session

3.15pm-3.45pm Afternoon Tea

Pre-Function Lounge, Level 17

3.45pm-4.30pm - SESSION 5

Function Room, Level 17

Collaborating to improve environmental, animal, and human
health outcomes in the Kimberley

Michelle Hayes, AMRRIC, Susan Stafford, Shire of
Derby/West Kimberley, WA

Regulating e-cigarettes in stores located near schools in SESLHD

Toby Hannan, South Eastern Sydney Public Health Unit, NSW

Q&A Session

Close day 2 and housekeeping

Program

Wednesday 15th May

TIME & SESSION

Speaker

8.00am - Registration and Arrival Coffee

Pre-Function Lounge, Level 17

8.55am-10.30am - **SESSION 6**

Function Room, Level 17

Call to attention and welcome

Healthy country, healthy people, healthy culture

Nathan Giles, First People of the Millewa-Mallee
Aboriginal Corporation, VIC

Healthy Community Events - MacDonnell Regional Council

Belinda Urquhart, Lisa Sharman and Elizabeth Taylor,
MacDonnell Regional Council, NT

Pest management in social housing - a bed bugs case study

Rob Barnett, NSW Health, NSW

Q&A Session

10.15am-10.45am Morning Tea

Pre-Function Lounge, Level 17

10.45am-12.15pm - **SESSION 7**

Function Room, Level 17

Aboriginal Health Council of Western Australia (AHCWA)

Prof. Jeanette Ward, AHCWA, Ray Christophers and
William 'Chicky' Clements, Nirrumbuk Environmental Health
and Services, WA

Q&A Session

Yarning about housing and environmental health in the
remote Kimberley

Stephanie Enkel, Telethon Kids Institute,
William 'Chicky' Clements, Nirrumbuk Environmental Health
and Services, WA

Have you got a plan? Emergency management of companion
animals when disaster strikes

Dr. Bonny Cumming AMRRIC and Nikki Gong, Wujal Wujal
Aboriginal Shire Council, QLD

Q&A Session

12.15pm-1.15pm Lunch

Pre-Function Lounge, Level 17

Excursions

Various locations

7.00pm-midnight Conference Awards Dinner proudly
supported by AMRRIC

Function Room, Level 17



RACV City Club Floor Plans

LEVEL 17

1. Function room
2. Outdoor terrace
3. Pre-function lounge
4. Restrooms
5. Green room

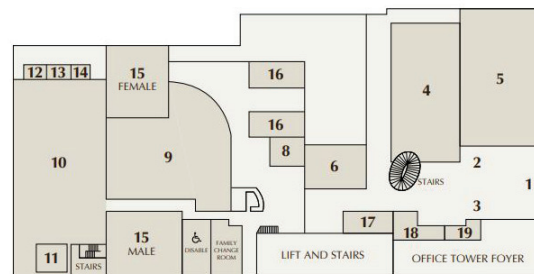
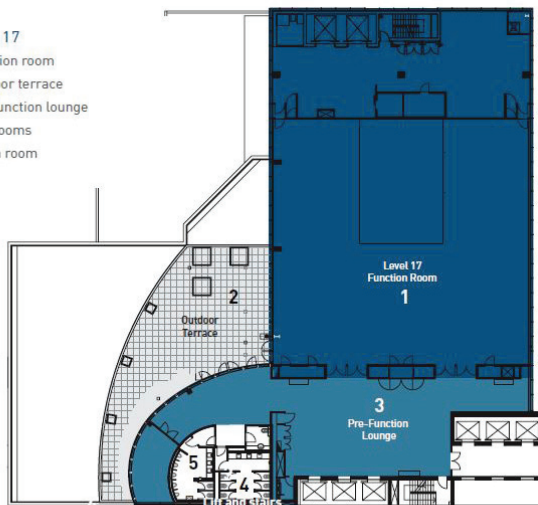

LEVEL

Ground
Bourke Street Level

1. Bourke Street Entry
2. Sign-in Desk
3. Concierge
4. Bistro
5. Bourke Street Green
6. Coffee Lounge
7. Fitness Centre Reception and Lounge
8. Barber
9. Gymnasium
10. Swimming Pool
11. Wading Pool
12. Sauna
13. Spa
14. Steam Room
15. Change
16. Assessment Rooms
17. Lobby Shop
18. Front Office Reception
19. Cloak Room

Thursday 16th May

TIME & SESSION

Speaker

9.00am - Registration and Arrival Coffee

Pre-Function Lounge, Level 17

9.25am-11.00am - SESSION 8

Function Room, Level 17

Call to attention and welcome

Sustaining progress towards the elimination of trachoma in Australia

Anne Marie Banfield¹, Alison Jaworski², Carleigh Cowling², Vanessa Garwood³, Liz Duggan³, Susana Vaz Nery² and John Kaldor²

¹National Aboriginal Community Controlled Health Organisation

²Nat. Trachoma Surveillance & Reporting Unit, Kirby Inst. UNSW Sydney

³First Nations Health Division, Department of Health and Aged Care

Environmental improvements towards the elimination of trachoma in Northern Territory regions

Emma Stanford, Walter Bathern and Lesley Martin, Indigenous Eye Health Unit, The University of Melbourne, Michelle McMasters, Central Australian Aboriginal Congress and Maxine Gallagher-Johns, Katherine West Health Board, VIC

Aboriginal Housing in Victoria

Darren Smith, CEO Aboriginal Housing Victoria

Clinician-driven integration of EH Referrals in ACCHOs

Samantha Barba, Pilbara Aboriginal Health Alliance, Scott Mackenzie, EH Trachoma Project, Joshua Evans, Mawarnkarra Health Service, WA

Q&A Session

11.00am-11.30am Morning Tea

Pre-Function Lounge, Level 17

11.30am-12.50pm - SESSION 9

Function Room, Level 17

Keynote Address

Prof. Tom Calma AO, National Coordinator Tackling Indigenous Smoking, ACT

Co-designing the environmental health future of Queensland's Aboriginal and Torres Strait Islander Communities

Kevin Toby and Uma Rajappa, Queensland Health, QLD

Unhealthy conditions in social housing – A changed approach

Skye-Ann Anderson, Lake Macquarie City Council, NSW

Q&A Session

12.50pm-1.50pm Lunch & Poster Presentations

Pre-Function Lounge, Level 17

1.15pm-1.35pm Poster Presentations

Function Room, Level 17

1.50pm-3.30pm - SESSION 10

Function Room, Level 17

Pigs in community and the risk of Japanese encephalitis virus (JEV) infection

Lachlan Chapman, NT Health, NT

The intersection of environmental health and trachoma and what it has meant for WA

Robert Mullane, Department of Health, WA

Trachoma: the driving force for a new way of working between environmental health and health

Matthew Lester, Department of Health, WA

Q&A Session

Summary of NATSIEH 2024 and Conference Close

Phillip Graham, Deputy Chair, ERPATSIEH

Disclaimer

The conference committee reserves the right to make alterations to the program as circumstances may require.